

PHOENIX MANUFACTURING, INC.

3655 E. Roeser Rd. - Phoenix, AZ 85040 *evapcool.com* 602-437-1034

SPECIFICATION DATA

INDUSTRIAL EVAPORATIVE ASPEN FAN COOLER MODEL: CF23 (UL LISTED)

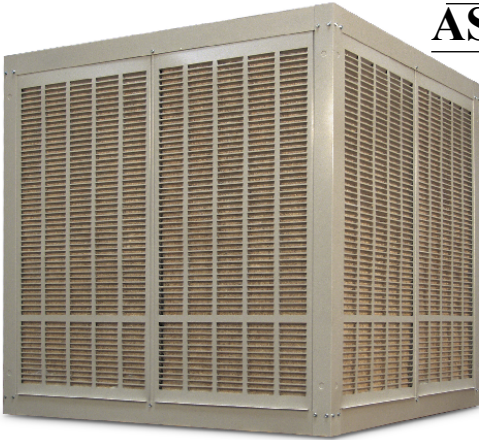

Industrial Evaporative Fan Cooler Features:

- Units are UL Listed to UL Standard 507.
- High quality architectural grade Peblar XT® finish.
- Galvanized sheet steel is zinc coated at weights rated G40 or G90.
- Up to 19,000 CFM capacity (Industry Standard Rating)
- Evaporative media used in the UL Listed models is rated to UL900.
- Three Phase EISA motors are NEMA MG-1 Table 12-12 compliant.
- Motor & Belt included.
- Bearings have an L10 bearing life of 39,000 hours.
- City of Los Angeles Approved.
- Solid shaft for strength & durability.
- Multilayer bottom pan finish.

PERFORMANCE

AIR DELIVERY - data published derived from tests conducted in accordance with A.M.C.A. (Air Movement and Control Assoc.) standard 210.

BEARING LIFE - L10 bearing life of 39,600 hours is based on ABMA standard 9/ISO standard 281.

MOTORS - recognized under UL component standard #1004 for motor certification.

SINGLE PHASE MOTORS - tested under UL standard 507 for locked rotor and heat rise protection.

THREE PHASE MOTORS - EISA motors are NEMA MG-1 Table 12-12 compliant.

PUMPS - recognized under the UL standard #778 for operating water pumps with thermal overload and locked rotor protection.

CONSTRUCTION

ASPEN PADS- Built to Federal Specification PP-E-911

DURA-COOL PADS - Used in UL Listed coolers is rated to UL900.

SEALANT - water immersion per ASTM D870.

FLEXIBILITY - per ASTM D756.

HOT DIPPED GALVANIZED SHEET STEEL - is ASTM A653, Type CS, with zinc coating weights rated G40 or G90.

CORROSION RESISTANCE - per ASTM B117.

POLYMERIC MATERIALS - listed in accordance with UL 94 and 746C.

BLOWER WHEEL - balanced in accordance with ISO 1940 and A.N.S.I. standard S2.19, quality grade G6.3. City of Los Angeles (C.O.L.A.), RR8075 Mechanical, RR930159 Electrical (1 1/2 HP Maximum, Single Phase).

PENCIL HARDNESS - per ASTM D3363.

IMPACT RESISTANCE - per D2794.

FLEXIBILITY- per ASTM D522.

SPECULAR GLOSS - per ASTM D523.

SURFACE BURNING CHARACTERISTICS - of building materials (best rating) per UL 723 and ASTM E-84.

PEBLAR XT® - is our one coat TGIC Polyester Powder Coating system that is applied over 5 stage zinc phosphate prepared sheet steel surfaces for protection against atmospheric corrosion. This coating system meets the requirements of UL 1332 - Organic Coatings for Steel Enclosures of Outdoor Use Electrical Equipment.

Phoenix Evaporative Coolers and components are designed and tested in accordance with one or more of the following standards or agencies:



AMCA Certified

Phoenix Manufacturing, Inc. certifies that the evaporative coolers shown are licensed to bear the AMCA seal. Cooler ratings are based on tests and procedures performed in accordance with AMCA publication 211 and comply with the requirements of the AMCA Certified Ratings Program.



UL Listed When used in non-ducted, single discharge applications as shown.



All data, specifications and detail contained in this publication are intended as a general guide for using PHOENIX MANUFACTURING, INC. PRODUCTS. These products should not be used in design or construction without an independent evaluation by a qualified engineer or architect to verify the suitability of a particular product for use in a specific application. PHOENIX MANUFACTURING, INC. assumes no liability for failure resulting from the use or misapplication of computation, detail drawings and specifications contained herein. This publication contains the latest information available at the time of printing. PHOENIX MANUFACTURING, INC. reserves the right to make modifications and/or change materials of any of their products without prior notice or obligation. PHOENIX MANUFACTURING, INC. may not produce all of the products contained in this submittal. For product availability and the latest information regarding products contact PHOENIX MANUFACTURING, INC.



PHOENIX MANUFACTURING, INC.

SUBMITTAL DATA

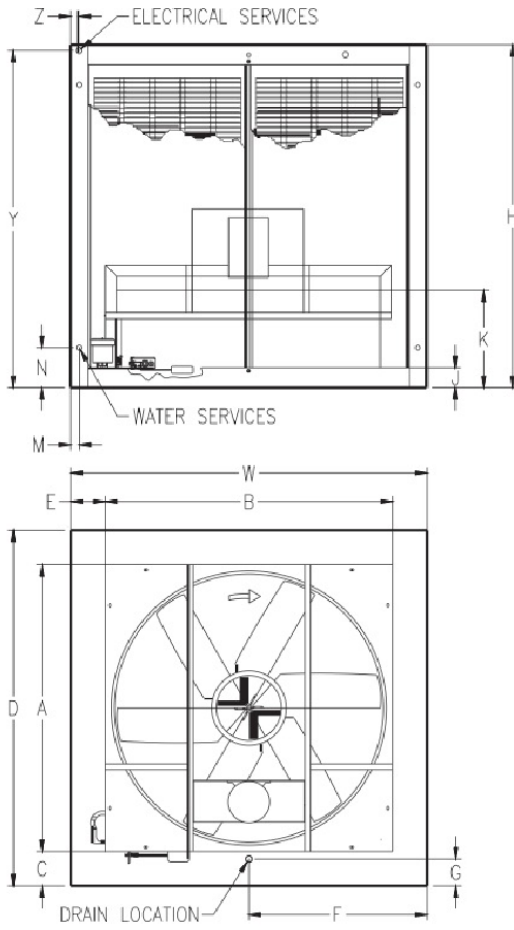

Project: _____ **Location:** _____

Architect: _____ **Engineer:** _____

Contractor: _____ **Submitted by:** _____

Notes: _____

Pump Specifications				
Pump Model	Volts	AMPS	Watts	GPM @ 6' Head
PK60LA	115	1.7	105	6.8
PK62LA	230	1.1	105	6.8

Performance shown is installation Type B - Free Inlet, duct outlet. Power Rating (B.H.P.) does not include drive losses. Performance ratings include the effects of evaporative media in the airstream.

Engineering Data

Cabinet Dimensions		Discharge Dimensions				Drain Location		Bottom Pan		Water Service		Electrical Service		Pad frame			Pad Filler Dimensions		Approximate Weight		
		Opening	Position					Depth	Riser												
H	W	D	A	B	C	E	F	G	J	K	M	N	Y	Z	H	W	QTY	HT	WD	Ship	Oper.
60	62	62	46	46	8	8	31	4 1/2	3 1/2	17	1 1/2	7	59	1 1/2	54 1/2	27 1/2	8	54	28	560	770

AMCA Certified Airflow & Electrical Data

Model	Motor Specifications					Pump Volts/Amps	Motor Amps	AMCA Certified Air Flow (CFM) @ Specified Static Pressure (inches of water)			
	Nameplate							0.0"	0.1"	0.2"	0.3"
	HP	BHp	Fan RPM	Voltage	Phase						
CF2301	1.0	1.15	458	115	1	115/3.4	13.2	16,100	14,200	11,000	7,300
CF2302	1.0	1.15	458	230	1	115/3.4	6.6	16,100	14,200	11,000	7,300
CF2303	1.0	1.15	458	208-230/460	3	115/3.4	3.2-3.1/1.6	16,100	14,200	11,000	7,300
CF2315	1.5	1.62	525	115	1	115/3.4	15.1	18,500	16,900	14,800	10,200
CF2312	1.5	1.62	525	230	1	115/3.4	7.6	18,500	16,900	14,800	10,200
CF2314	1.5	1.62	525	208-230/460	3	115/3.4	4.6-4.8/2.4	18,500	16,900	14,800	10,200
CF2322	2.0	2.20	579	230	1	115/3.4	8.5	N/A	19,000	17,200	14,800
CF2324	2.0	2.20	579	208-230/460	3	115/3.4	6.0-5.8/2.9	N/A	19,000	17,200	14,800