



Productivity Through Energy Efficient

# Comfort

Energy Efficiency,  
Exceptional Performance >>

Aspen Industrial Fan Coolers, in the correct low static application, offer an energy efficient alternative to standard blower wheel units at a fraction of the operating cost. Designed for large areas *with cooling needs to match*, these units can save up to 70% in energy costs.

- 19,000 CFM High Capacity Fan
- 70% Less Energy Costs
- Meets or Exceeds Most Local & national Codes
- U.L. Listed

## More Air - Less Energy

These highly efficient, commercial grade blades deliver more air while using less horsepower than a comparable sized blower wheel model. Designed for open spaces applications such as warehouses, factories, manufacturing areas, laundries ect., this specially designed six-blade fan provides the maximum air delivery. Approximately 19,000 cfm at 0.0' static pressure can be obtained using only a 2 HP motor!

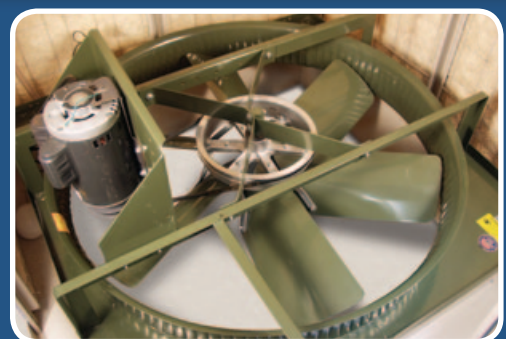

## U.L. Listed For Safety

These high capacity units are U.L. listed for safety when used in non-ducted, single discharge applications as seen to the left. All units are completely pre-wired with factory installed and tested motor and circulating pump systems. This Phoenix Manufacturing, Inc. unit will meet or exceed most local and national codes.



U.L. Listed when used in non-ducted, single discharge applications as shown.

# Aspen Industrial Coolers

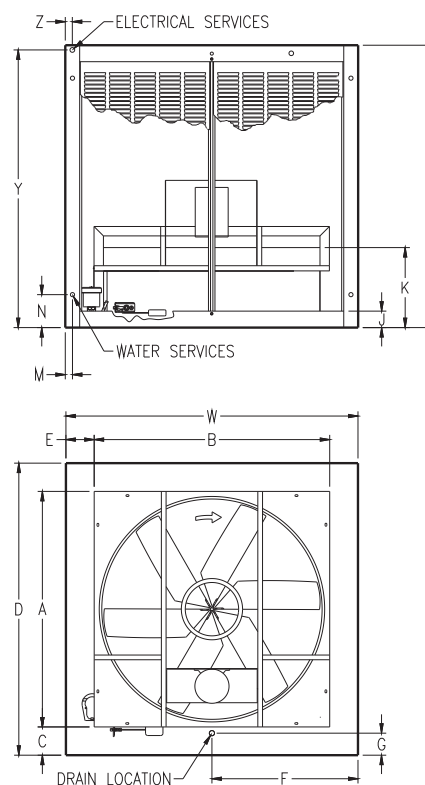
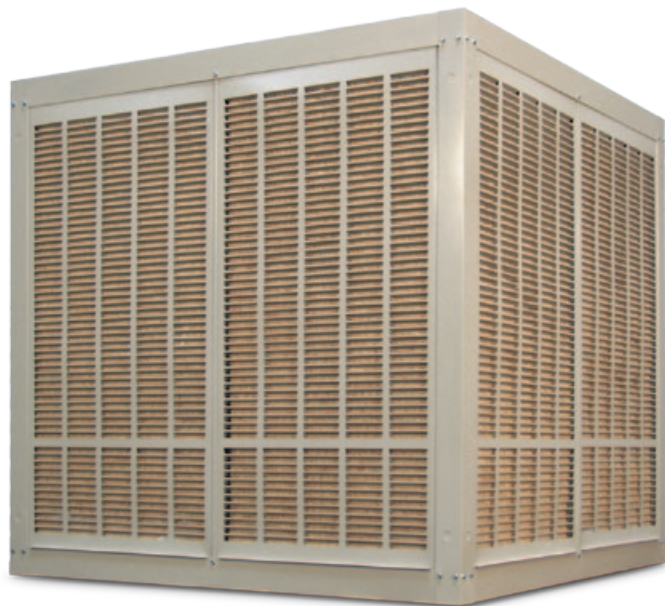

### Aspen Industrial Cooler Feature:

- Up to 19,000 CFM Capacity
- AMCA licensed ratings
- Hot dipped galvanized steel construction cabinet
- UL Listed
- Peblar XT™ architectural finish, protects against rust

### Engineering Data

Cabinet Dimensions			Discharge Dimensions				Drain Location		Bottom Pan		Water Service		Electrical Service		Pad Frame			Pad Filler Dimensions		Approx. Weight	
			Opening		Position																
H	W	D	A	B	C	E	F	G	J	K	M	N	Y	Z	HT	WIDTH	QTY	HT.	WIDTH	SHIP	OPER.
60	62	62	46	46	8	8	31	4 2/3	3 1/2	17	1 1/2	7	59	1 1/2	54 1/3	27 1/2	8	54	28	560	770

### Electrical Data and Certified Air Delivery

Model Number	Motor Specifications						Pump Voltage/Amperage	Static Pressure (Inches Water) And AMCA Certified Air Flow (CFM)			
	Nameplate HP	BHp	Fan RPM	Voltage	Amperage	Phase		0.0"	0.1"	0.2"	0.3"
CF2301	2.2	1.15	458	115	13.2	1	115/1.7	16,100	14,200	11,000	7,300
CF2302	2.2	1.15	458	230	6.6	1	115/1.7				
CF2304	2.2	1.15	458	208-240/480	3.6/1.7	3	115/1.7				
CF2315	1.5	1.62	525	115	15.1	1	115/1.7	18,500	16,900	14,800	10,200
CF2312	1.5	1.62	525	230	7.6	1	115/1.7				
CF2314	1.5	1.62	525	208-240/480	4.6/2.2	3	115/1.7				
CF2322	2	2.2	579	230	8.5	1	115/1.7	19,000	17,200	14,800	
CF2324	2	2.2	579	208-240/480	7.1/3.3	3	115/1.7				



Phoenix Manufacturing, Inc. certifies that the evaporative coolers shown are licensed to bear the AMCA seal. The ratings shown are based on tests and procedures performed in accordance with AMCA publication 211 and comply with the requirements of the AMCA Certified Ratings Program.

- Performance certified is for installation type B: free inlet, ducted outlet.
  - Performance ratings include the effect of evaporative media.
  - Power (BHP) includes transmission losses.
1. All external wiring and components such as disconnects, motor starters, and over-current protection are to be field supplied and are not included as part of the evaporative cooler from the factory.
  2. A separate 120 volt, 60 hertz, single phase, GFCI protected pump circuit is required to maintain the UL Listing of the evaporative cooler. Pump capacity shown is total for 2 pumps per evaporative cooler.

Phoenix Evaporative Coolers and components are designed and tested in accordance with one or more of the following standards or agencies: **AIR DELIVERY** - data published derived from tests conducted in accordance with A.M.C.A. (Air Movement and Control Assoc.) standard 210. **ASPEN PADS** - built to federal specification PP-E-911 for Type 1, Class A, Grade 4. **SEALANT** - water immersion per ASTM D870. **FLEXIBILITY** - per ASTM D756. **CORROSION RESISTANCE** - per ASTM B117. **PENCIL HARDNESS** - per ASTM D3363. **IMPACT RESISTANCE** - per D2794. **FLEXIBILITY** - per ASTM D522. **SPECULAR GLOSS** - per ASTM D523. **SURFACE BURNING CHARACTERISTICS** of building materials (best rating) per UL 723 and ASTM E-84. **PUMPS** recognized under the UL standard #778 for operating water pumps with thermal overload and locked rotor protection. **POLYMERIC MATERIALS** listed in accordance with UL 94 and 746C. **MOTORS** recognized under UL component standard #1004 for motor certification. **MOTORS** tested under UL standard #547 for locked rotor and heat rise protection. **BLOWER WHEEL** - balanced in accordance with ISO 1940 and A.N.S.I. standard S2.19, quality grade G6.3.



**PHOENIX MANUFACTURING, INC.**  
"Committed to Customer Success"™

Phoenix Manufacturing Inc.  
3655 East Roeser Road  
Phoenix, Arizona 85040  
Phone: 602-437-1034  
Fax: 602-437-4833  
www.evapcool.com

FKFAN\_10\_V04  
MADE IN U.S.A.